

Sideshifting fork positioner

frame version, constant sideshift

ZVR

The **fork positioner ZVR** uses a robust round bar system that is bolted to a stable frame. The constant sideshift operates in every fork position. Hook-on forks can be used as well as bolt-on forks. The attachment can be mounted onto fork truck carriages that are narrower than the attachment itself.

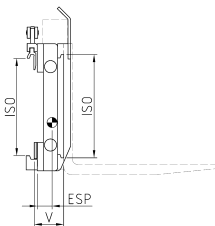
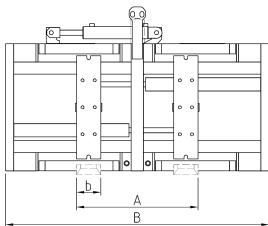

type	lift truck capacity tons	capacity kg/mm LC	ISO	B mm	opening range A mm	b mm	V LLC mm	ESP COG mm	weight kg	sideshift mm
ZVR 25	1,5-2,5	2500/500	II	1150 1300	320-1050 320-1200	120 120	130 130	81 81	250 266	+/- 100
ZVR 30	3,0-3,5	3500/500	III	1150 1300	320-1050 320-1200	125 125	130 130	81 81	270 286	+/- 100
ZVR 45	4,0-5,0/600	5000/600	III	1350 1600	370-1250 370-1500	140 140	146 146	92 92	340 372	+/- 100
ZVR 50	5,0	5000/600	IV	1420 1600	380-1300 380-1480	150 150	159 159	109 109	515 540	+/- 100
ZVR 60	6,0	6000/600	IV	1600 1800	380-1480 380-1680	150 150	168 168	118 118	645 691	+/- 100
ZVR 80	7,0-8,0	8000/600	IV	2000	480-1880	200	205	138	885	+/- 150
ZVR 100	8,0/900	8000/900	IV	2000	480-1880	200	220	148	985	+/- 150

- fork prices upon request
- includes hoses and couplings
- 2 hydraulic functions required
- option sideshift via valve
- hook-on forks or bolt-on forks can be used
- excludes forks

options	weight reduced by	LLC reduced by
integral sideshift (via valve) instead of constant sideshift	35 kg	15 mm
integral sideshift (via valve) instead of constant sideshift	50 kg	15 mm
integral sideshift (via valve) instead of constant sideshift	110 kg	22 mm

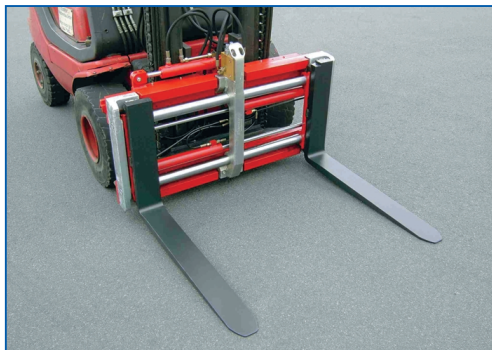

DURWEN 
Forklift Attachments

More than 60 years experience