

Paper roll clamp 360°

long arm split

PRK-T

The **paper roll clamp PRK-T** is able to take rolls vertically or horizontally and rotates 360°. Due to a split long arm the clamp allows handling of two reels with different diameter. The short arm can be chosen fixed (PRK-TS) or variable positioned (PRK-TB) with an extra cylinder. The rotation is provided by the Durwen direct drive rotator.

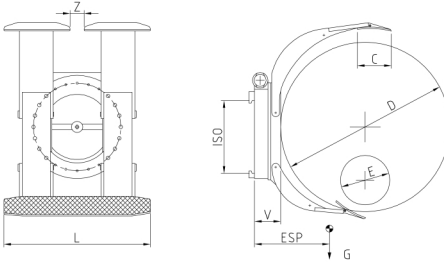

type	lift truck capacity tons	ISO	capacity kg	short arm	roll diameter E-D mm	contact pads c x l mm	Z mm	V LLC mm	ESP COG mm	weight kg
PRK 20 - TS	2,0 - 2,5	II	1300/650	fixed	400 - 1300	220 x 700	120	187	250	560
PRK 20 - TB	2,0 - 2,5	II	1300/650	variable	250 - 1300	220 x 700	120	187	240	565
PRK 25 - TS	2,5	II	1800/650	fixed	400 - 1300	220 x 700	120	190	200	640
PRK 25 - TB	2,5	II	1800/650	variable	250 - 1300	220 x 700	120	190	205	645
PRK 30 - TB	3,0	III	1750/800	variable	250 - 1600	220 x 700	120	170	390	695
PRK 35 - TB	3,5	III	2000/800	variable	250 - 1600	250 x 800	200	165	235	825
PRK 35 - TB	3,5	III	2500/650	variable	250 - 1300	250 x 800	200	190	230	750
PRK 40 - TB	4,0	III	2500/800	variable	250 - 1600	250 x 800	200	193	350	1070
PRK 45 - TB	4,5	III	3500/650	variable	250 - 1300	250 x 900	200	206	360	970
PRK 45 - TB	4,5	III	2800/800	variable	250 - 1600	250 x 900	200	198	300	1073
PRK 50 - TB	5,0 - 6,0	IV	3700/800	variable	250 - 1600	250 x 900	250	200	390	1160
PRK 60 - TB	6,0	IV	4000/800	variable	250 - 1600	280 x 1200	250	250	400	1240
PRK 80 - TB	7,0-8,0	IV	3300/1025	variable	550 - 2050	280 x 1200	250	200	445	1830
PRK 100 - TB	8,0/900	IV	4000/1025	variable	550 - 2050	280 x 1200	250	220	415	1930

- 2 hydraulic functions required
- includes hoses and couplings
- safety break as standard
- 10 mm rubber coated pads upon request
- 20 mm rubber coated pads upon request
- standard pad surface structured steel
- other pad surfaces upon request

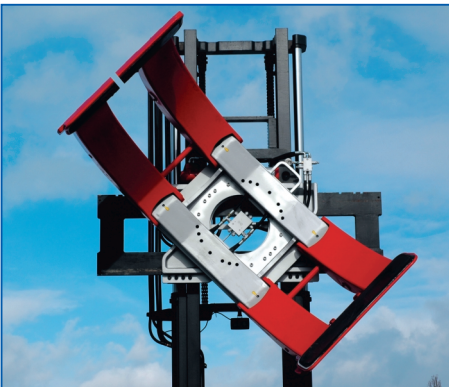

DURWEN 
Forklift Attachments

More than 60 years experience