

# Paper roll clamp 360°

**PRK**

The **paper roll clamp PRK** is able to take rolls vertically or horizontally and rotates 360°. The short arm can be chosen fixed (PRK-S) or variable positioned (PRK-B) due to an extra cylinder. The rotation is provided by the Durwen direct drive rotorator.

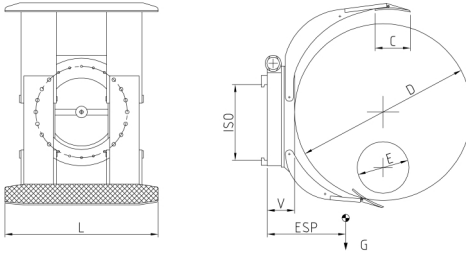

type	lift truck capacity tons	ISO	capacity kg	short arm	roll diameter E-D mm	contact pads c x l mm	V LLC mm	ESP COG mm	weight kg
PRK 20 - S	2,0 - 2,5	II	1300/650	fixed	400 - 1300	220 x 700	187	250	570
PRK 20 - B	2,0 - 2,5	II	1300/650	variable	250 - 1300	220 x 700	187	240	575
PRK 25 - S	2,5	II	1800/650	fixed	400 - 1300	220 x 700	190	205	630
PRK 25 - B	2,5	II	1800/650	variable	250 - 1300	220 x 700	190	200	635
PRK 30 - B	3,0	III	1750/800	variable	250 - 1600	220 x 700	170	395	705
PRK 35 - B	3,5	III	2000/800	variable	250 - 1600	250 x 800	165	240	835
PRK 35 - B	3,5	III	2500/650	variable	250 - 1300	250 x 800	190	235	760
PRK 40 - B	4,0	III	2500/800	variable	250 - 1600	250 x 800	193	355	1080
PRK 45 - B	4,5	III	3500/650	variable	250 - 1300	250 x 900	206	305	980
PRK 45 - B	4,5	III	2800/800	variable	250 - 1600	250 x 900	198	365	1083
PRK 50 - B	5,0 - 6,0	IV	3700/800	variable	250 - 1600	250 x 900	200	400	1170
PRK 60 - B	6,0	IV	4000/800	variable	250 - 1600	280 x 1200	250	405	1250
PRK 80 - B	7,0-8,0	IV	3300/1025	variable	550 - 2050	280 x 1200	200	440	1840
PRK 100 - B	8,0/900	IV	4000/1025	variable	550 - 2050	280 x 1200	220	420	1940

- 2 hydraulic functions required
- includes hoses and couplings
- safety break as standard
- 10 mm rubber coated pads upon request
- 20 mm rubber coated pads upon request
- standard pad surface structured steel
- other pad surfaces upon request

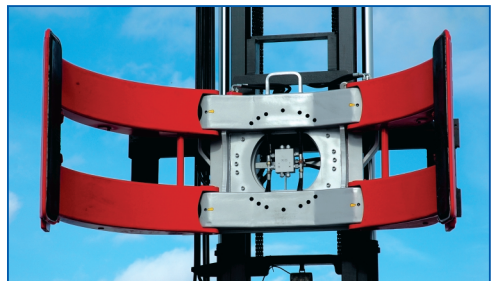
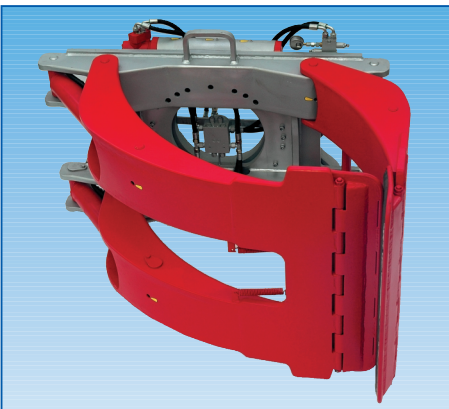

**DURWEN**   
Forklift Attachments

More than 60 years experience